

2M Series Sub-Miniature Single Pole Toggle Switches

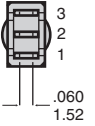
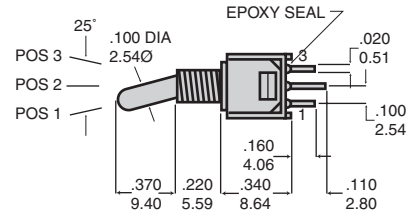
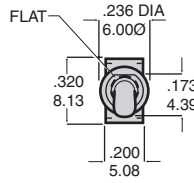

No. Poles	UL/CSA Model No.	Model No.	SWITCH FUNCTION			CONNECTED TERMINALS		
			Pos. 1	Pos. 2	Pos. 3	Pos. 1	Pos. 2	Pos. 3
SP	Q2211	2MS1	On	None	On		OPEN	
	Q2212	2MS2	On	None	Mom			
	Q2213	2MS3	On	Off	On			
	Q2214	2MS4	Mom	Off	Mom			
	Q2215	2MS5	On	Off	Mom			
	Q2216	2MS6	Off	None	On			

MOM=Momentary

Specifications

- Contact Rating:** Dependent upon contact material
- Electrical Life:** 30,000 make-and-brake cycles at full load.
- Contact Resistance:** 20m Ω max. initial @ 2-4VDC
100mA for both silver and gold plated contacts.
- Insulation Resistance:** 1,000M Ω min.
- Dielectric Strength:** 1000 V RMS@sea level
- Operating Temperature:** -30° C to 85° C

Materials

- Case:** Diallyl phthalate (DAP)(UL-94V-0)
- Actuator:** Brass, chrome plated
- Bushing:** Brass, nickel plated
- Housing:** Stainless Steel
- Switch Support:** Brass, tin plated
- Terminals/Contact:** Brass, with Silver or gold plated

Ordering Information

Model No.	Actuator	Bushing	Terminations	Contact Material	Seal
UL/CSA	T1*	B1	M1	Q=Silver R= Gold	E=Epoxy N=No Epoxy
Q2211 2MS1	T2*	B2	M2		
Q2212 2MS2	T3*	B3	M6		
Q2213 2MS3	T4**	B4	M7		
Q2214 2MS4	T5**	B5	VS2		
Q2215 2MS5		B6	VS3		
Q2216 2MS6		B7			
		B8			

Contact Material Options

Q
Fixed Terminal: Silver plated copper alloy
Moving Contact: Silver plated copper alloy
Rated: 3 Amps @ 120VAC or 28VDC;
1 Amps @ 250VAC

R
Fixed Terminal: Copper alloy with gold plated over nickel plated
Moving Contact: Copper alloy with gold plated over nickel plated
Rated: .04 VA max. @ 20VAC or DC MAX.

DIM. 'A'

.370 (9.40)*
.210 (5.33)*
.290 (7.37)*
.410 (10.41)**
.220 (5.59)**

*Actuator shown with B1 or B3 bushing, subtract 0.09 (2.29) for B5 bushing, subtract 0.041 (1.02) for B7 bushing.
**Actuator shown with B5 bushing, add 0.09 (2.29) for B1 and B3 bushing, add 0.05 (1.27) for B7 bushing.



Phone (203) 272-2794 • Fax (203) 272-3492 • <http://www.osloswitch.com>

MADE IN U.S.A.

2M Series Sub-Miniature Double Pole Toggle Switches

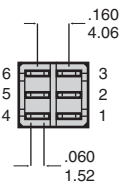
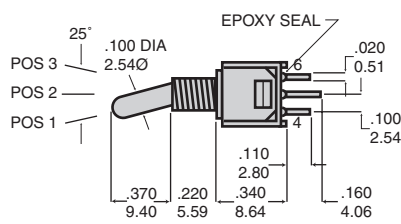
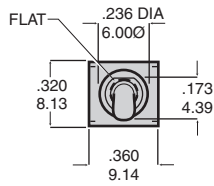
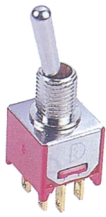

No. Poles	UL/CSA Model No.	Model No.	SWITCH FUNCTION			CONNECTED TERMINALS		
			Pos. 1	Pos. 2	Pos. 3	Pos. 1	Pos. 2	Pos. 3
DP	Q2221	2MD1	On	None	On		OPEN	
	Q2222	2MD2	On	None	Mom			
	Q2223	2MD3	On	Off	On			

MOM=Momentary

Specifications and Materials: See page 1.

Ordering Information

Model No.	Actuator	Bushing	Termination	Contact Material	Seal
UL/CSA Q2221 2MD1 Q2222 2MD2 Q2223 2MD3	T1* T2* T3* T4** T5**	B1 B2 B3 B4 B5 B6 B7 B8	M1 M2 M6 M7 VS2 VS3	Q=Silver R= Gold Contact Material Options Q Fixed Terminal: Silver plated copper alloy Moving Contact: Silver plated copper alloy Rated: 3Amps @ 120VAC or 28VDC; 1Amps @ 250VAC R Fixed Terminal: Copper alloy with gold plated over nickel plated Moving Contact: Copper alloy with gold plated over nickel plated Rated: .04 VA max. @ 20VAC or DC MAX.	E=Epoxy N=No Epoxy

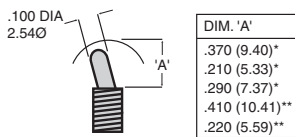

*Actuator shown with B1 or B3 bushing, subtract 0.09 (2.29) for B5 bushing, subtract 0.041 (1.02) for B7 bushing.
**Actuator shown with B5 bushing, add 0.09 (2.29) for B1 and B3 bushing, add 0.05 (1.27) for B7 bushing.



Phone (203) 272-2794 • Fax (203) 272-3492 • <http://www.osloswitch.com>

2M Series Sub-Miniature Double Pole Toggle Switches

Bushing Options

B1 THD
B2 NON-THD

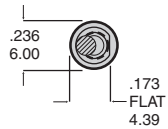

B3 THD
B4 NON-THD

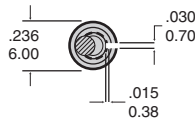

B1-B4

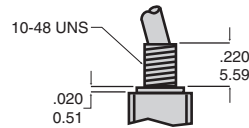

B5 THD
B6 NON-THD

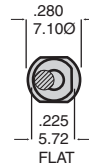

B7 THD
B8 NON-THD

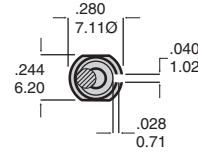

B5-B8

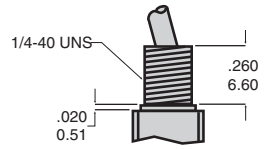

Panel Cutout

10-48 BUSHING

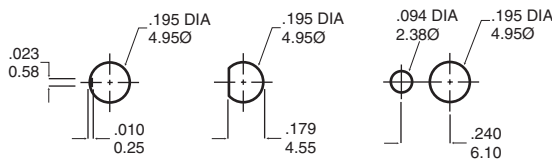

Without locking ring

With Std. locking ring

1/4 in. BUSHING

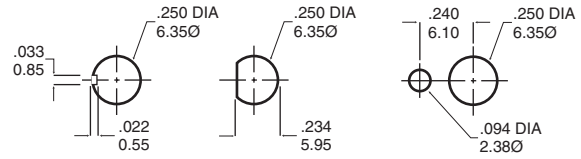

Without locking ring

With Std. locking ring

Termination Options

M1

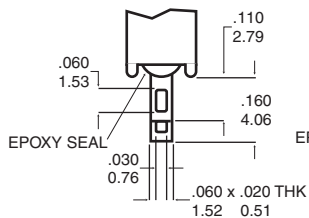

Single Pole

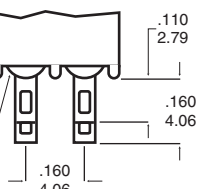

Double Pole

M2

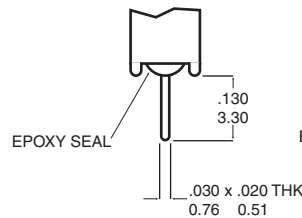

Single Pole

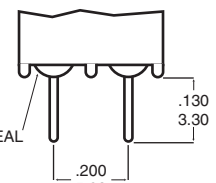

Double Pole

M6 SPDT

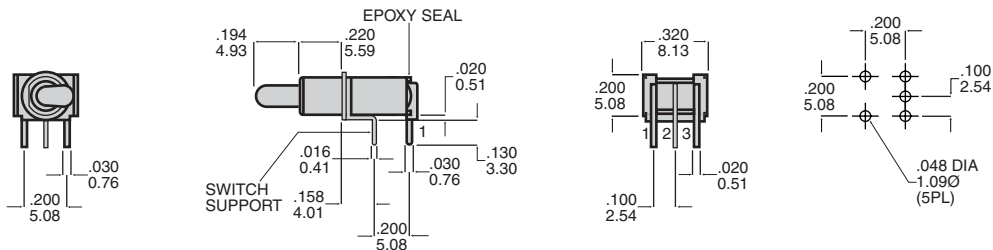

Termination Options (continued)

M6 DPDT

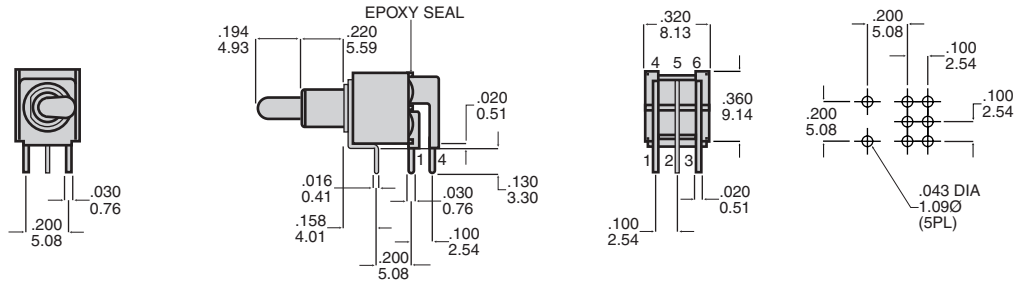

M7 SPDT

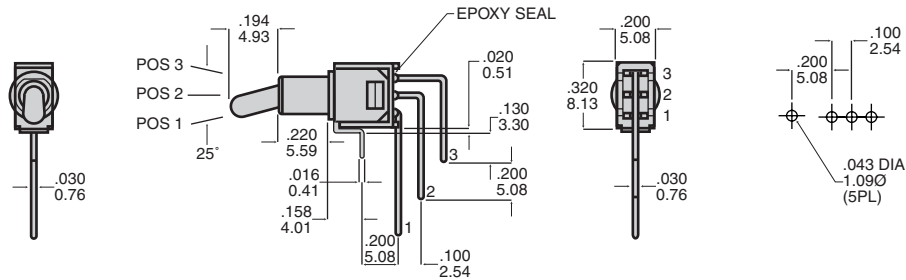

M7 DPDT

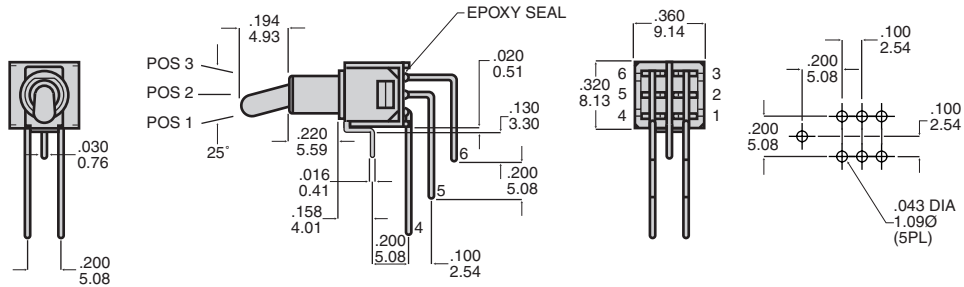

VS2 SPDT

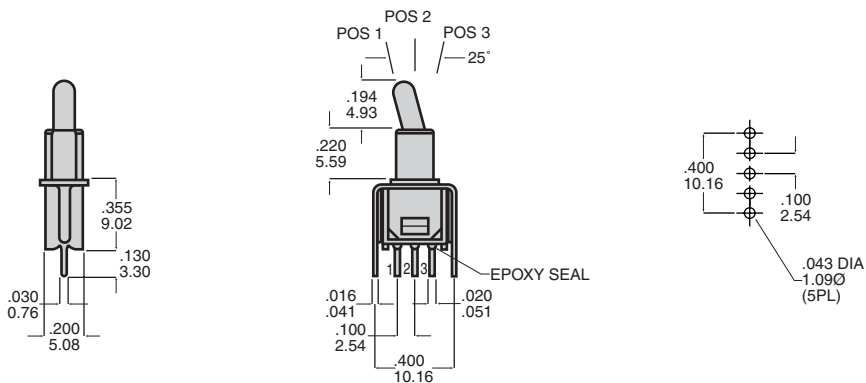

VS3 DPDT

